

DELTA SYSTEM 500 - EXISTING SOLID WALL DETAIL:-

SYSTEM 500 FLOOR APPLICATION SEALED AT DPC. LEVEL.
 THE DPC. CAN BE A CHEMICAL DPC. (AS SHOWN) OR A
 PHYSICAL DPC. CAN BE CUT AND SEALED TO SYSTEM 500.

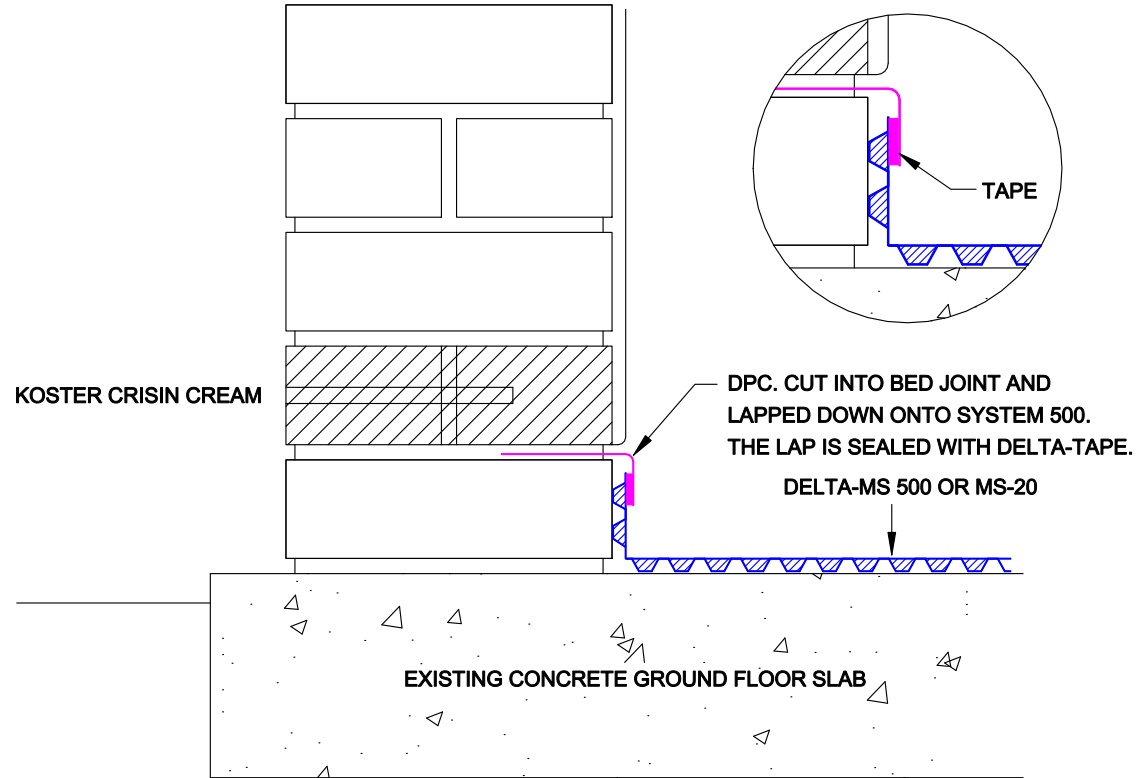

DELTA MEMBRANE SYSTEMS LTD.

DRAWING No: DDP-106-1
 DRAWING TITLE: DELTA SYSTEM 500 - EXISTING SOLID WALL / FLOOR DETAIL

DELTA HOUSE, MERLIN WAY, NORTH WEALD, EPPING, ESSEX CM16 6HR
 TEL: 01992 523523 FAX: 01992 523250

OFFICE USE:
 REVISION No: 1
 Drawn By:
 Checked By:
 Scale:
 REVISION DATE: May 2017
 System Files: PDF / DWG

DRAWING NOTE:
 This drawing is for illustrative purposes only. Drawing not to scale.

PROJECT / COMMENTS:

DRAWING NOTES:
 All installations to be carried out in strict accordance with manufacturer's installations instructions.
 For further assistance contact Delta Technical on 01992 523 523 or email technical@deltamembranes.com