

**STAGE 1**

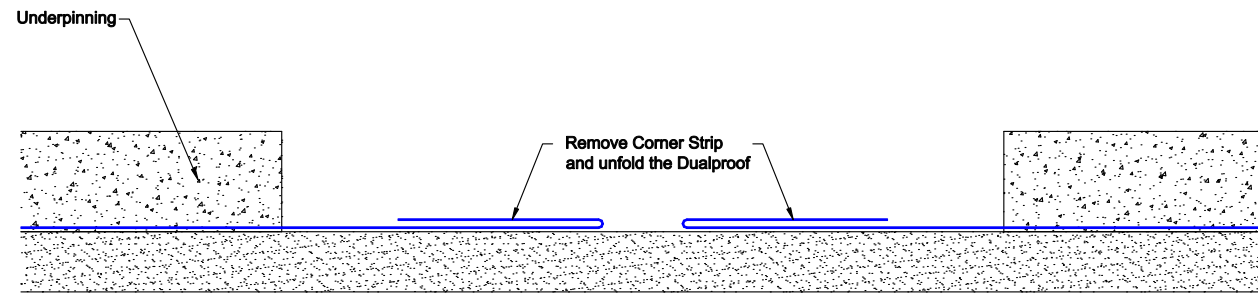

**STAGE 2**

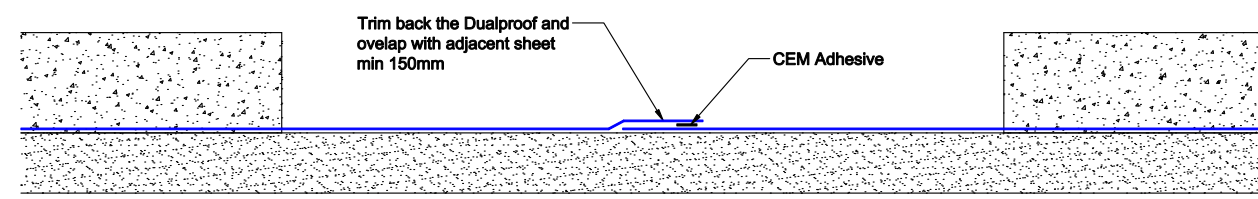

**STAGE 3**

**DELTA** MEMBRANE SYSTEMS LTD.

DRAWING No: DW-202-1- (D)

DRAWING TITLE: DUAL PROOF - UNDERPINNING 2

DELTA HOUSE, MERLIN WAY, NORTH WEALD, EPPING, ESSEX CM16 6HR  
 TEL: 01992 523523 FAX: 01992 523250

OFFICE USE:

REVISION No:  
1

Drawn By:  
Checked By:

REVISION DATE:  
June 2017

Scale:  
System Files: PDF / DWG

DRAWING NOTE:  
This drawing is for illustrative purposes only. Drawing not to scale.

PROJECT / COMMENTS:

DRAWING NOTES:  
All installations to be carried out in strict accordance with manufacturer's installations instructions.  
For further assistance contact Delta Technical on 01992 523 523 or email technical@deltamembranes.com