

**COMBINED WATERPROOFING - INTERNAL  
KOSTER NB1 / DELTA CAVITY DRAINAGE**

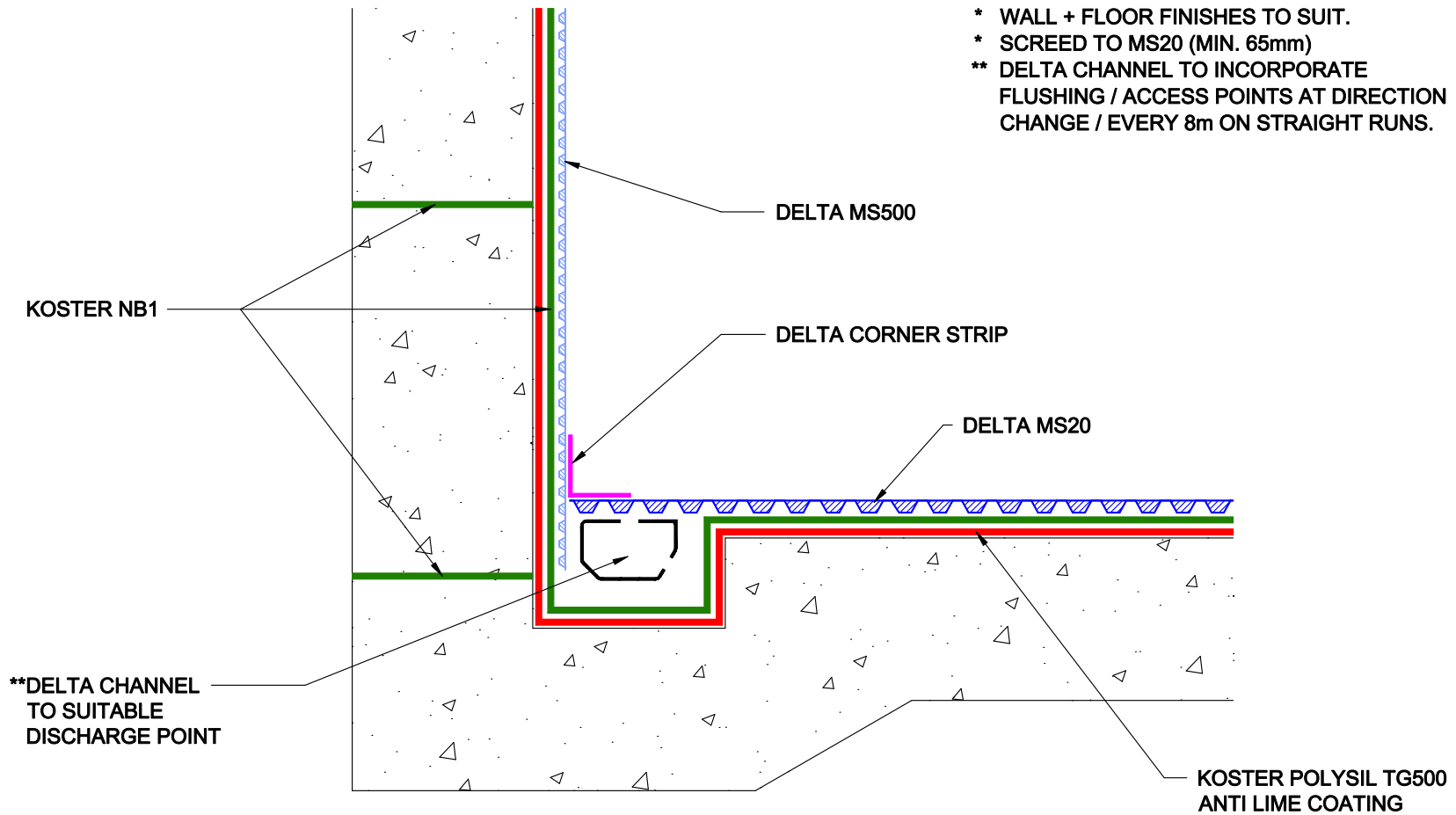

- \* WALL + FLOOR FINISHES TO SUIT.
- \* SCREED TO MS20 (MIN. 65mm)
- \*\* DELTA CHANNEL TO INCORPORATE FLUSHING / ACCESS POINTS AT DIRECTION CHANGE / EVERY 8m ON STRAIGHT RUNS.

**DELTA** MEMBRANE SYSTEMS LTD.

DRAWING No: DW-208-1- (D)

DRAWING TITLE: INTERNAL COMBINED SYSTEM - NB1 / DELTA MS

DELTA HOUSE, MERLIN WAY, NORTH WEALD, EPPING, ESSEX CM16 6HR  
TEL: 01992 523523 FAX: 01992 523250

OFFICE USE:

REVISION No:  
1

REVISION DATE:  
June 2017

Drawn By:  
Checked By:  
Scale:  
System Files: PDF / DWG

DRAWING NOTE:

This drawing is for illustrative purposes only. Drawing not to scale.

PROJECT / COMMENTS:

DRAWING NOTES:  
All installations to be carried out in strict accordance with manufacturer's installations instructions.  
For further assistance contact Delta Technical on 01992 523 523 or email technical@deltamembranes.com