

DETAILING TO DRY PACK - FOR DELTA MS CAVITY DRAIN SYSTEM

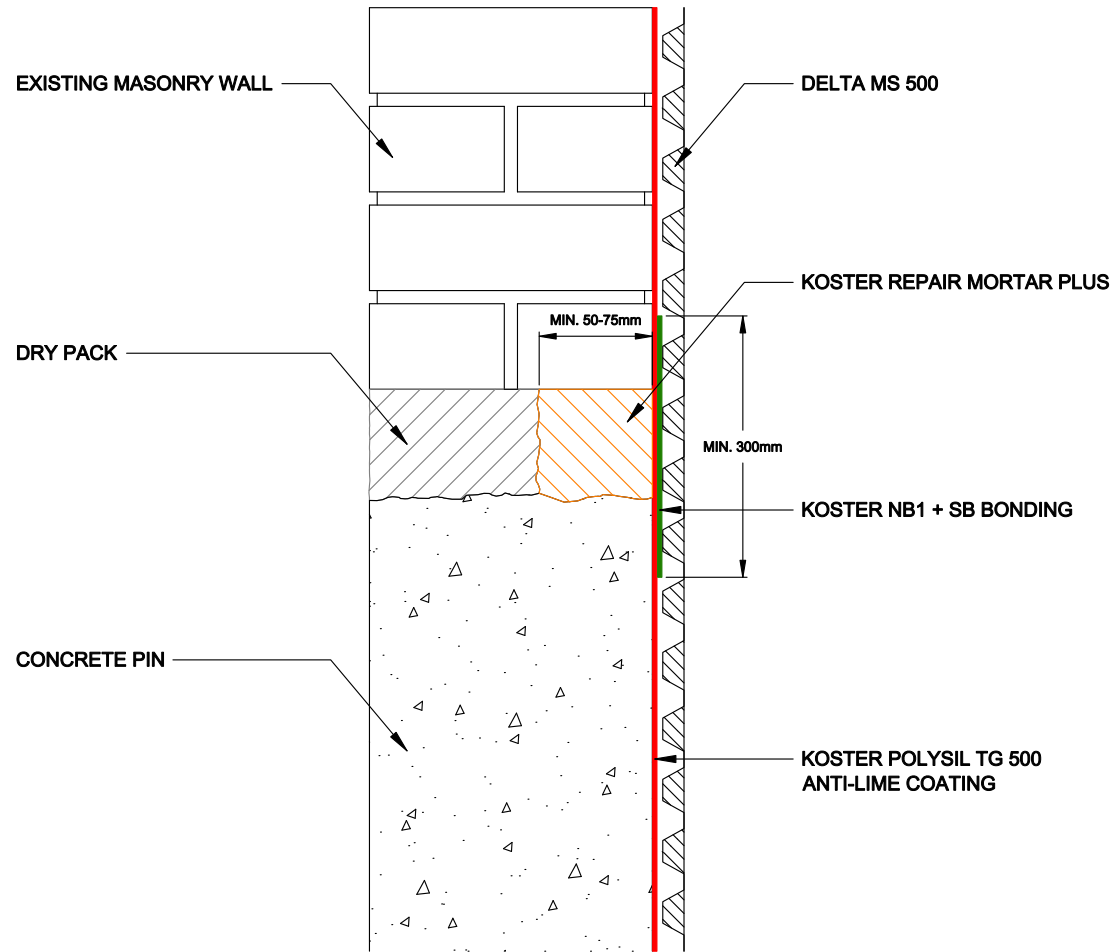

DELTA MEMBRANE SYSTEMS LTD.

DRAWING No: DW-215-1-(C)
 DRAWING TITLE: DETAILING TO DRY PACK - FOR DELTA MS CAVITY DRAIN SYSTEM

DELTA HOUSE, MERLIN WAY, NORTH WEALD, EPPING, ESSEX CM16 6HR
 TEL: 01992 523523 FAX: 01992 523250

OFFICE USE:

REVISION No: 1
 REVISION DATE: June 2017
 Drawn By:
 Checked By:
 Scale:
 System Files: PDF / DWG

DRAWING NOTE:

This drawing is for illustrative purposes only. Drawing not to scale.

PROJECT / COMMENTS:

DRAWING NOTES:
 All installations to be carried out in strict accordance with manufacturer's installations instructions.
 For further assistance contact Delta Technical on 01992 523 523 or email technical@deltamembranes.com