

DELTA DUAL PROOF - PILED WALLS

PLAN VIEW

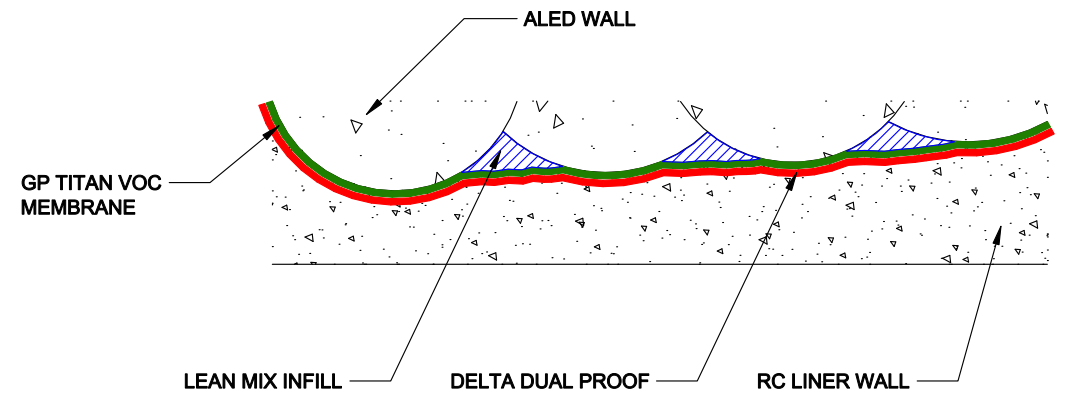
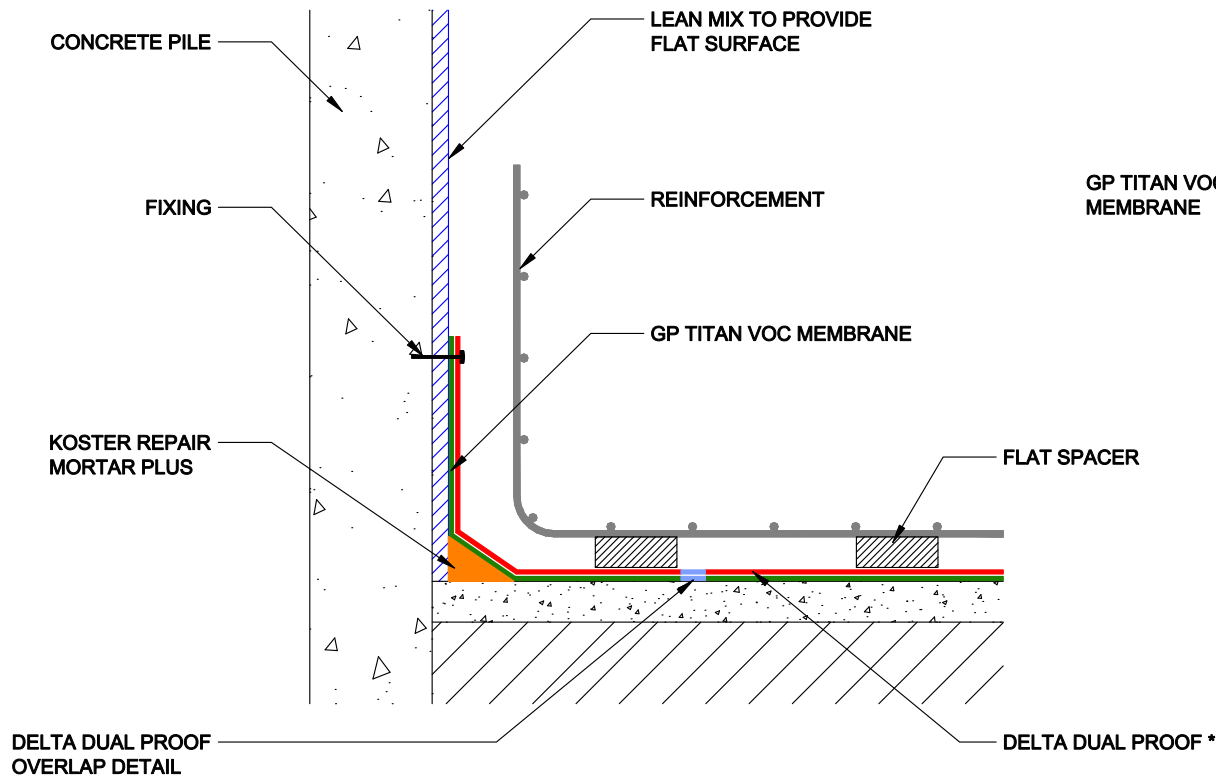

* THE UNDERSLAB DELTA DUAL PROOF SHOULD TERMINATE AT LEAST 150mm ABOVE THE TOP OF THE POURED SLAB

DELTA MEMBRANE SYSTEMS LTD.

DRAWING No: DGS-304-1-(E)

DRAWING TITLE: DELTA DUAL PROOF - PILED WALLS

DELTA HOUSE, MERLIN WAY, NORTH WEALD, EPPING, ESSEX CM16 6HR
 TEL: 01992 523523 FAX: 01992 523250

OFFICE USE:

REVISION No:

1

REVISION DATE:

July 2017

Drawn By:

Checked By:

Scale:

System Files: PDF / DWG

DRAWING NOTE:

This drawing is for illustrative purposes only. Drawing not to scale.

PROJECT / COMMENTS:

DRAWING NOTES:

All installations to be carried out in strict accordance with manufacturer's installations instructions. For further assistance contact Delta Technical on 01992 523 523 or email technical@deltamembranes.com