

TYPICAL PERIMETER SECTION 2

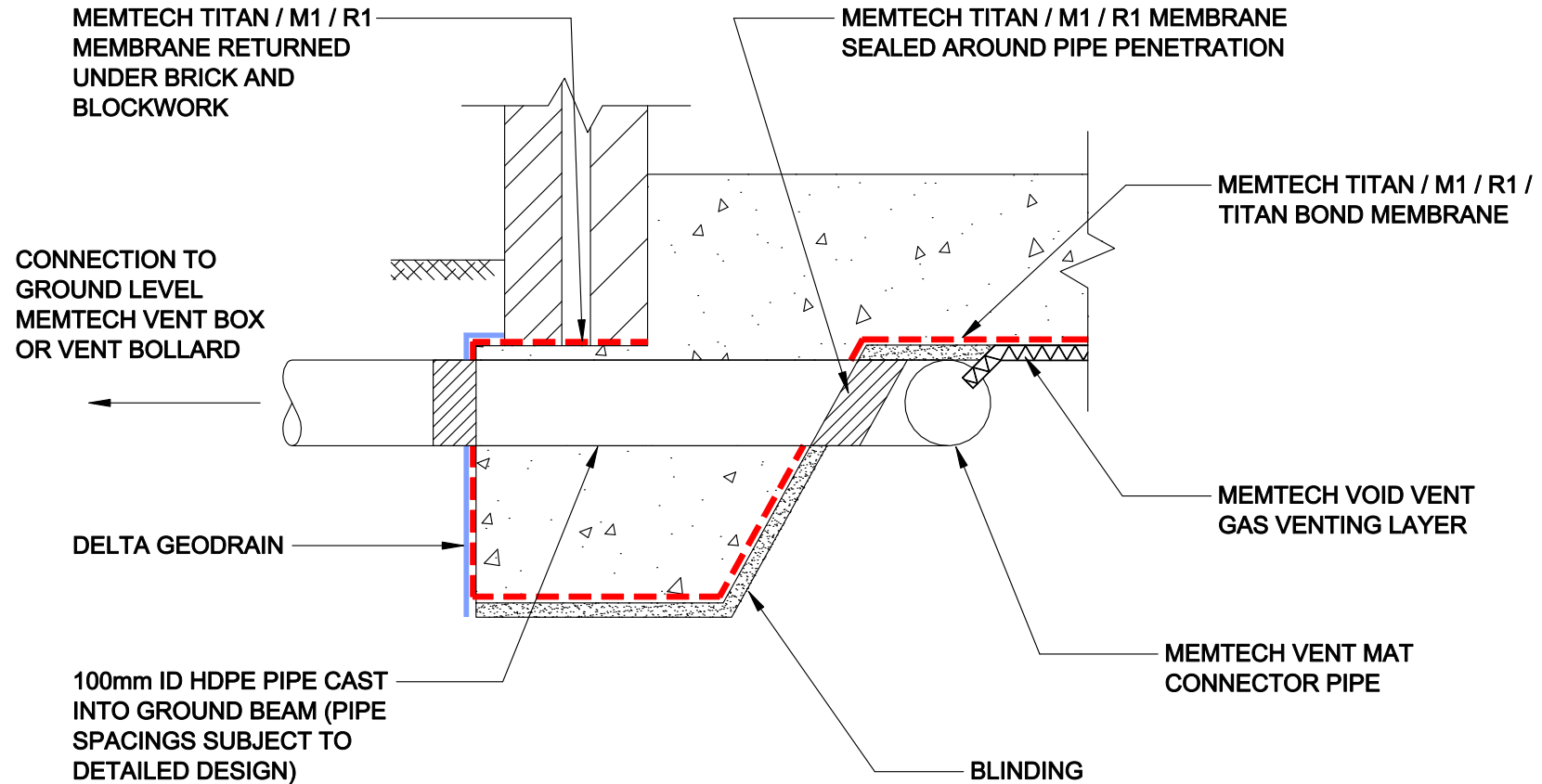

DRAWING No: DGS-323-1
 DRAWING TITLE: MEMTECH - TYPICAL PERIMETER SECTION 2

DELTA HOUSE, MERLIN WAY, NORTH WEALD, EPPING, ESSEX CM16 6HR
 TEL: 01992 523523 FAX: 01992 523250

OFFICE USE:
 REVISION No: 1
 Drawn By:
 Checked By:
 Scale:
 System Files: PDF / DWG
 REVISION DATE: April 2018

DRAWING NOTE:
 This drawing is for illustrative purposes only. Drawing not to scale.

PROJECT / COMMENTS:

DRAWING NOTES:
 Memtech Titan provides both a waterproof membrane and Hydrocarbon and VOC barrier in accordance with BS 8102 (2009) and BS 8485: 2015